

# MASKING PLUGS

## CORKS 300°F (150°C)

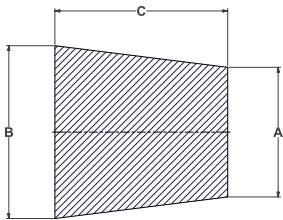

- Recommended for painting applications
- Can be cut to desired length
- Can be used for shipping protection to keep debris out of holes

| Part Number | Imperial (in)   |                  |                 | Quantity Per Bag |
|-------------|-----------------|------------------|-----------------|------------------|
|             | A               | Metric (mm)<br>B | C               |                  |
| RC0000      | 0.093<br>2.38   | 0.187<br>4.76    | 0.500<br>12.70  | 1000             |
| RC000       | 0.156<br>3.97   | 0.250<br>6.35    | 0.500<br>12.70  | 1000             |
| RC00        | 0.218<br>5.56   | 0.312<br>7.94    | 0.500<br>12.70  | 1000             |
| SC0         | 0.234<br>5.95   | 0.312<br>7.94    | 0.375<br>9.53   | 1000             |
| RC0         | 0.281<br>7.14   | 0.375<br>9.53    | 0.500<br>12.70  | 1000             |
| RC1         | 0.328<br>8.33   | 0.437<br>11.11   | 0.625<br>15.88  | 1000             |
| SC1         | 0.343<br>8.73   | 0.437<br>11.11   | 0.500<br>12.70  | 1000             |
| RC2         | 0.375<br>9.53   | 0.500<br>12.70   | 0.6875<br>17.46 | 1000             |
| SC2         | 0.406<br>10.32  | 0.500<br>12.70   | 0.500<br>12.70  | 1000             |
| RC3         | 0.421<br>10.72  | 0.562<br>14.29   | 0.750<br>19.05  | 1000             |
| SC3         | 0.468<br>11.91  | 0.562<br>14.29   | 0.500<br>12.70  | 1000             |
| RC4         | 0.468<br>11.91  | 0.625<br>15.88   | 0.8125<br>20.64 | 1000             |
| SC4         | 0.531<br>13.49  | 0.625<br>15.88   | 0.500<br>12.70  | 1000             |
| RC5         | 0.531<br>13.49  | 0.687<br>17.46   | 0.875<br>22.23  | 1000             |
| SC5         | 0.562<br>14.29  | 0.687<br>17.46   | 0.625<br>15.88  | 1000             |
| RC6         | 0.5781<br>14.68 | 0.750<br>19.05   | 0.9375<br>23.81 | 1000             |
| SC6         | 0.625<br>15.88  | 0.750<br>19.05   | 0.625<br>15.88  | 1000             |
| RC7         | 0.625<br>15.88  | 0.812<br>20.64   | 1.000<br>25.40  | 1000             |
| SC7         | 0.671<br>17.07  | 0.812<br>20.64   | 0.750<br>19.05  | 1000             |
| RC8         | 0.671<br>17.07  | 0.875<br>22.23   | 1.0625<br>26.99 | 1000             |
| SC8         | 0.734<br>18.65  | 0.875<br>22.23   | 0.750<br>19.05  | 1000             |
| RC9         | 0.734<br>18.65  | 0.937<br>23.81   | 1.125<br>28.58  | 100              |
| SC9         | 0.796<br>20.24  | 0.937<br>23.81   | 0.750<br>19.05  | 100              |
| RC10        | 0.765<br>19.45  | 1.000<br>25.40   | 1.250<br>31.75  | 100              |
| SC10        | 0.812<br>20.64  | 1.000<br>25.40   | 1.000<br>25.40  | 100              |
| RC11        | 0.828<br>21.03  | 1.062<br>26.99   | 1.250<br>31.75  | 100              |
| RC12        | 0.890<br>22.62  | 1.125<br>28.58   | 1.250<br>31.75  | 100              |

## CORKS 300°F (150°C)

| Part Number | Imperial (in)  |                  |                | Quantity Per Bag |
|-------------|----------------|------------------|----------------|------------------|
|             | A              | Metric (mm)<br>B | C              |                  |
| RC13        | 0.953<br>24.21 | 1.187<br>30.16   | 1.250<br>31.75 | 100              |
| RC14        | 1.015<br>25.80 | 1.250<br>31.75   | 1.250<br>31.75 | 100              |
| RC15        | 1.078<br>27.38 | 1.312<br>33.34   | 1.250<br>31.75 | 100              |
| RC16        | 1.093<br>27.78 | 1.375<br>34.93   | 1.500<br>38.10 | 100              |
| RC17        | 1.156<br>29.37 | 1.437<br>36.51   | 1.500<br>38.10 | 100              |
| RC18        | 1.218<br>30.96 | 1.500<br>38.10   | 1.500<br>38.10 | 100              |
| RC19        | 1.281<br>32.54 | 1.562<br>39.69   | 1.500<br>38.10 | 100              |
| RC20        | 1.343<br>34.13 | 1.625<br>41.28   | 1.500<br>38.10 | 100              |
| RC22        | 1.468<br>37.31 | 1.750<br>44.45   | 1.500<br>38.10 | 100              |
| RC24        | 1.593<br>40.48 | 1.875<br>47.63   | 1.500<br>38.10 | 100              |
| RC26        | 1.718<br>43.66 | 2.000<br>50.80   | 1.500<br>38.10 | 100              |
| RC28        | 1.843<br>46.83 | 2.1250<br>53.98  | 1.500<br>38.10 | 100              |
| RC30        | 1.968<br>50.01 | 2.250<br>57.15   | 1.500<br>38.10 | 100              |

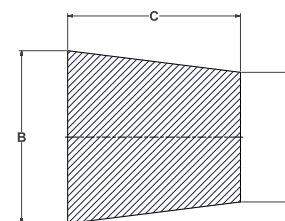

- Recommended for painting applications
- Can be cut to desired length

## SELF-THREADING PLUGS 180°F (82°C)

| Part Number | Thread Size |         | Quantity Per Bag |
|-------------|-------------|---------|------------------|
|             | From        | To      |                  |
| STP-2       | 2-56        | 2-64    | 500              |
| STP-3       | 3-48        | 3-56    | 500              |
| STP-4       | 4-40        | 4-48    | 500              |
| STP-6       | 6-32        | 6-40    | 500              |
| STP-8       | 8-32        | 8-36    | 500              |
| STP-10      | 10-24       | 10-32   | 500              |
| STP-12      | 12-24       | 12-28   | 100              |
| STP-1/4     | 1/4-20      | 1/4-28  | 100              |
| STP-5/16    | 5/16-18     | 5/16-24 | 100              |
| STP-3/8     | 3/8-16      | 3/8-24  | 100              |
| STP-1/2     | 1/2-13      | 1/2-20  | 100              |



- Recommended for plating, anodizing and spray painting
- Self tapping
- Creates a leak proof seal
- Holes can be used for hanging
- Chemical resistant